

USER MANUAL

Thermal Overload Relay

CR09~32



Disconnect all power before installing, modifying or servicing equipment. Electric shock will result in death or serious injury. Only skilled & qualified personnel should carry out the following operations and must adhere to all appropriate national, regional and local standards applicable.

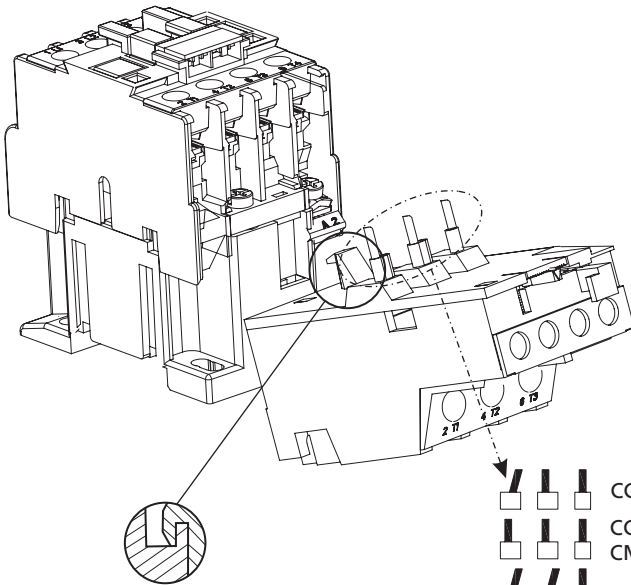

- CC32
- CC25
- CMB09-25/CMB32
- CC18
- CC09-12

Pin positions for mounting

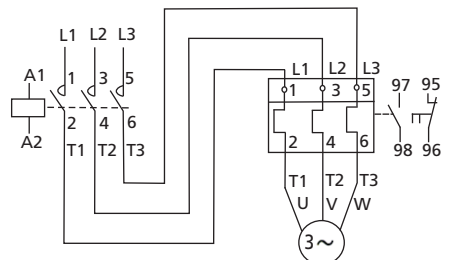
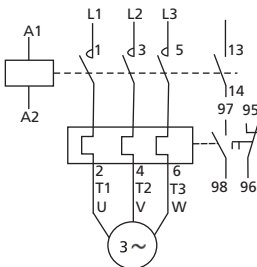

Dimensional Diagram:

Mounted directly beneath contactors CC09-32

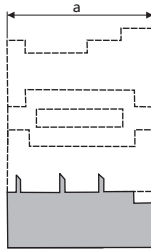
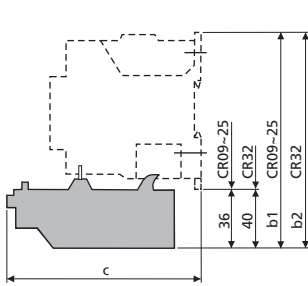

	CC09-18	CC25-32
a	45	56
b1	110	120
b2	113	124
c	105	117

Independent mounting

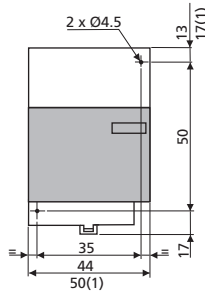
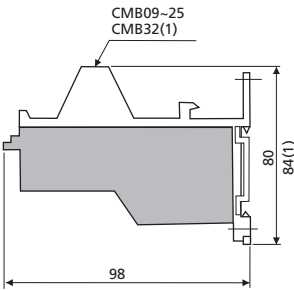

Note: Dimensions marked (1) are for CR32.

Wiring Capability:

Load Terminals			Head Type	CR09-25	CR32			
Screw Plate		Solid Wire	mm ²	Combi-head (Slot/Phillips)	2 x 1...6	2 x 1.5...10		
		Stranded Wire	mm ²		2 x 0.75...4	2 x 1.5...6		
		AWG Wire			2 x 18...10	2 x 18...10		
		Standard Gauge			A5 / B4	A5 / B5		
		Tightening Torque	Nm/lb.in		1.85 / 16.4	2.5 / 22.1		
		Tightening Torque(UL)	lb.in		15	20		
				Ø 6	Phillips No.2			

Auxiliary Terminals			Head Type	CR09-32			
Screw Plate		Solid Wire	mm ²	Combi-head (Slot/Phillips)	2 x 1...2.5		
		Stranded Wire	mm ²		2 x 0.75...1.5		
		AWG Wire			2 x 18...14		
		Standard Gauge			A2 / B2		
		Tightening Torque	Nm/lb.in		1.2 / 10.6		
		Tightening Torque(UL)	lb.in		7		
				Ø 6	Phillips No.2		

CAUTION

Terminal screws must be tightened at recommended torque and checked frequently.
All strands of cable shall go into the terminal of each phase.