

① Overload Adjustment

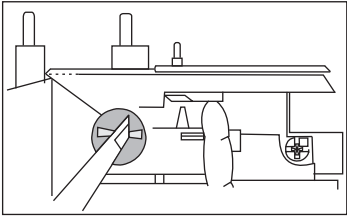

④ Trip Indicator

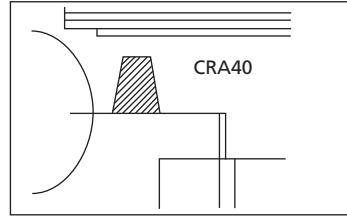

② Sealing Cover

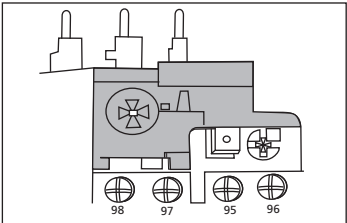

⑤ Reset Function

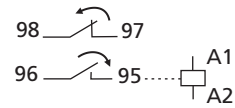
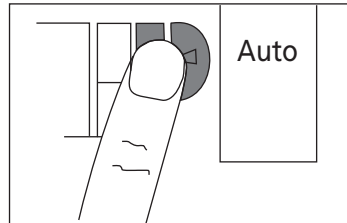

③ Manual Auto Reset

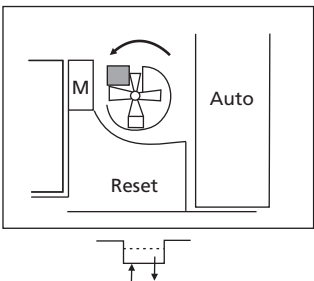

⑥ Stop Function

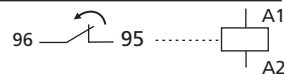
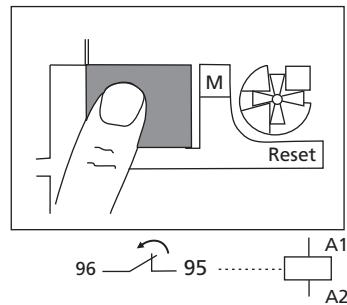

USER MANUAL

Thermal Overload Relay

CRA40~80



Disconnect all power before installing, modifying or servicing equipment. Electric shock will result in death or serious injury. Only skilled & qualified personnel should carry out the following operations and must adhere to all appropriate national, regional and local standards applicable

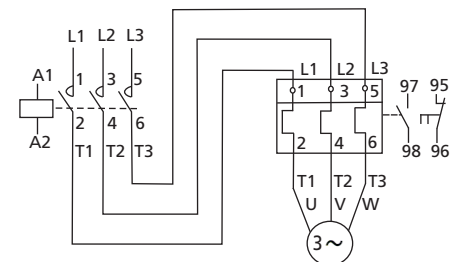
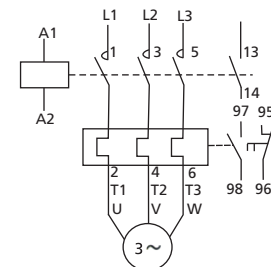
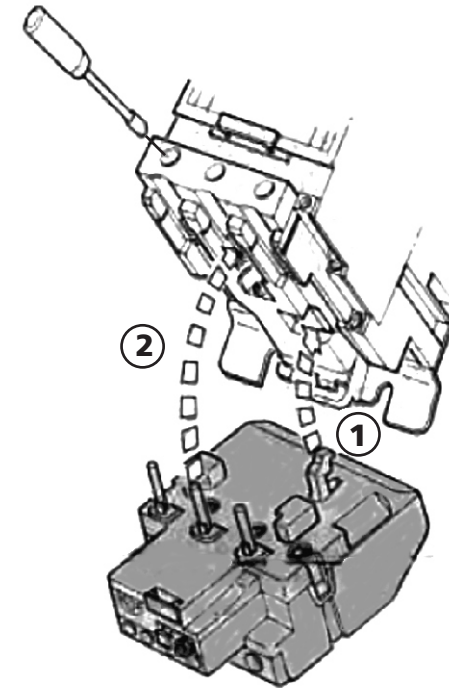

Crompton Controls Ltd.

Monckton Road, Wakefield, West Yorkshire WF2 7AL
 Phone: +44 (0)1924 368251 Fax: +44 (0)1924 367274
 E-mail: sales@cromptoncontrols.co.uk, www.cromptoncontrols.co.uk

XXXXX



Dimensional Diagram:

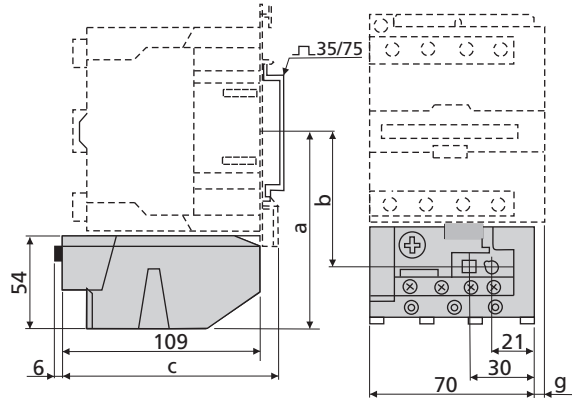

CC+CRA40~80		
	CC40 CC50 CC65	CC80
a	111	115.5
b	72.4	76.9
c	119	123.5
g (3P)	4.5	9.5
g (4P)	9.5	15

Independent Mounting:

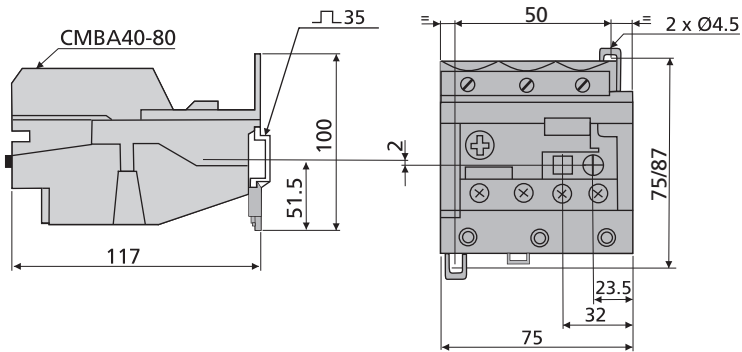

Wiring Min. Max. :

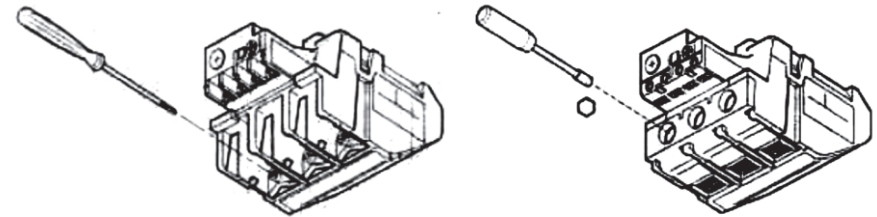

Wiring Capability:

Load Terminals			Head Type	CRA40~80			
Clamp		Solid Wire	mm ²	Slot/hex.Socket Head	2 x 4...25		
		Stranded Wire	mm ²				2 x 4...25
		AWG Wire					2 x 12...2
		Standard Gauge					2 x A4..B9
		Tightening Torque	Nm/lb.in				9 / 79.5
		Tightening Torque(UL)	lb.in		75		
Auxiliary Terminals			Head Type	CRA40~80			
Screw Plate		Solid Wire	mm ²	Combi-head (Slot/Phillips)	2 x 1...2.5		
		Stranded Wire	mm ²				2 x 0.75...1.5
		AWG Wire					2 x 18...14
		Standard Gauge					A2 / B2
		Tightening Torque	Nm/lb.in				1.2 / 10.6
		Tightening Torque(UL)	lb.in		7		

CAUTION
Terminal screws must be tightened at recommended torque and checked frequently. All strands of cable shall go into the terminal of each phase.

Control Circuit Test (Trip Test):

